

# DESCALER®

## DESCALER PS - INSTALLATION INSTRUCTIONS

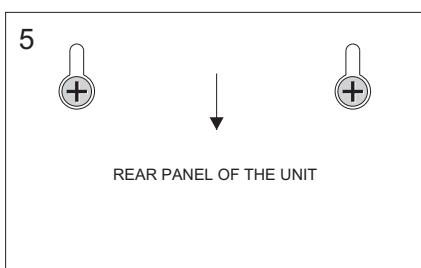
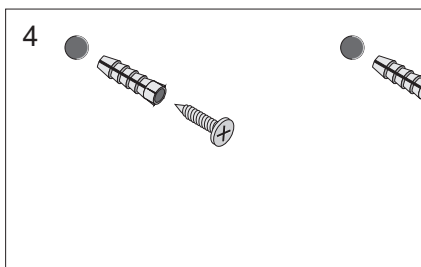
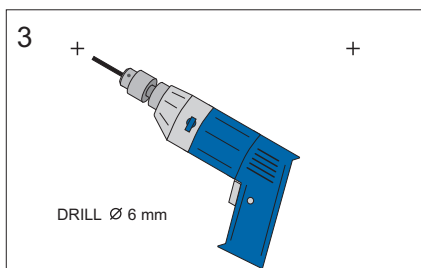
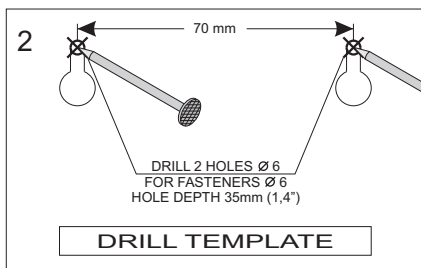
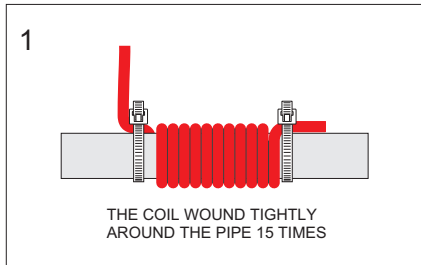

The installation consists of wrapping 2 field coils next to each other around the water-supply pipe, fixing the box onto the wall and connecting the coil and the box.

### Installation of the coil:

Wrap 2 coils each 15 times (see fig.1) around the horizontal or vertical pipe while the distance between the ends of the coils and the bends, valves, joints, etc must be minimum three times the outer diameter of the pipe in order to avoid unwanted water turbulence in the place where the coils are wound. The direction of the winding is not important. Tightly fix the ends of both coils with plastic bands. The length of the loose ends of the wire should be approximately of the same length.

### Installation of the box:

Use the drilling jig and a sharp tipped object to mark holes not far from the coils. Then drill the holes of the diameter of 6 mm. Put wall plugs into the holes and drive in screws so that their heads jut out over the wall by about 5 mm. There are openings on the rear cover of the electronic unit; put the box on the wall the way that the screw heads get through the openings and slide the box downwards.

Fig.1

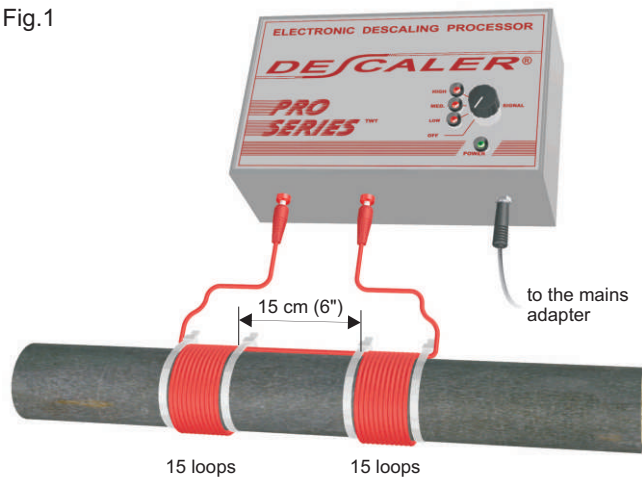

### PUTTING INTO OPERATION:

Plug the connectors into the outlets of the unit. The wire leads should not be too tight and they must not be entwined together.

The unit is powered by 12 V= direct regulated current from the mains adapter. Connect the power supply to the unit and plug the adapter into an electrical socket. The green LED (POWER) indicates the proper functioning.

The red LED is blinking, and at the same time a discontinuous acoustic sound can be heard, after the coil circuit was interrupted, for example, after unplugging the connector or if there is no signal in the output connectors (failure).

It is necessary to place the mains adapter in the environment where there is no threat of splattering water. In case there is the possibility of splattering water, it is necessary to place the mains adapter into the case IP 54.